



**Shire of Halls Creek**

**Local Planning Scheme No. 2 –**

**Proposed Omnibus Amendment 1 maps**

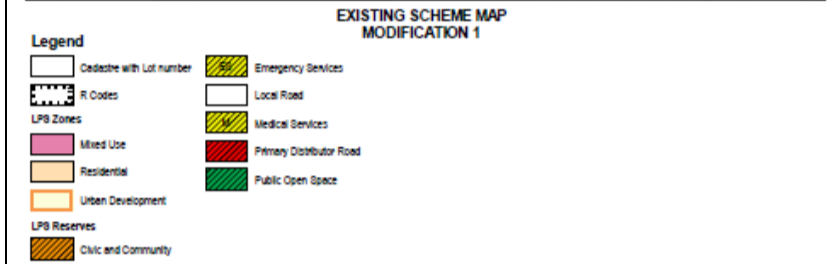
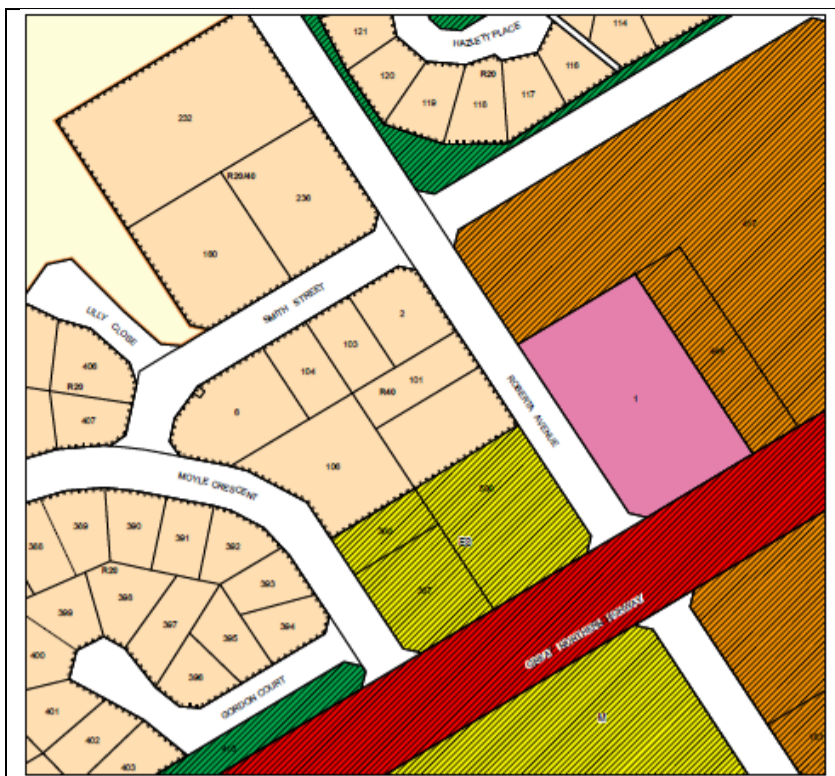

Figure 1 Modification No. 3.1

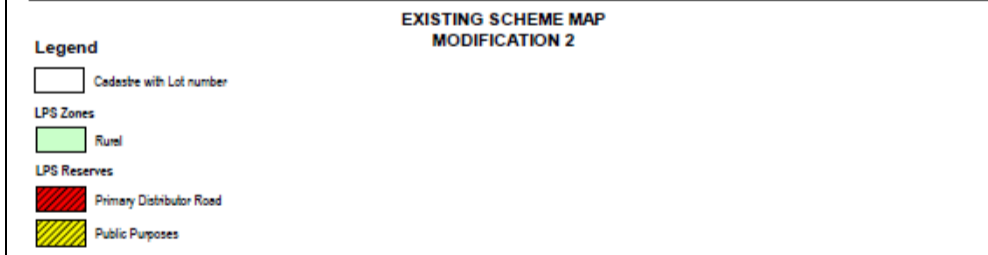
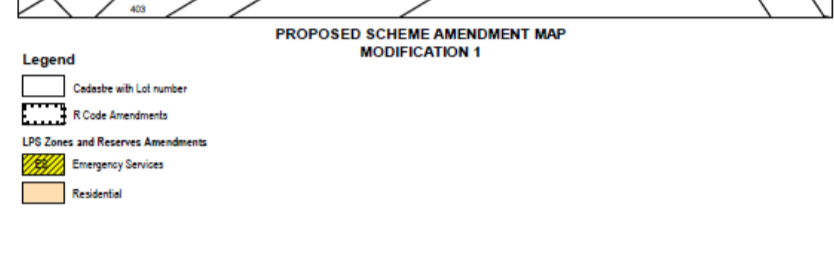
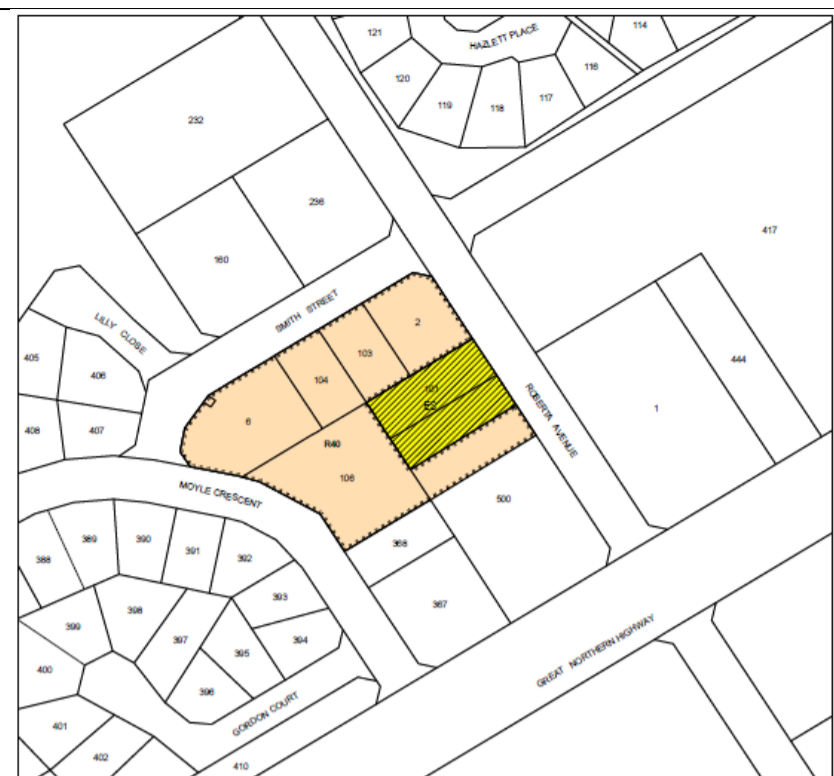
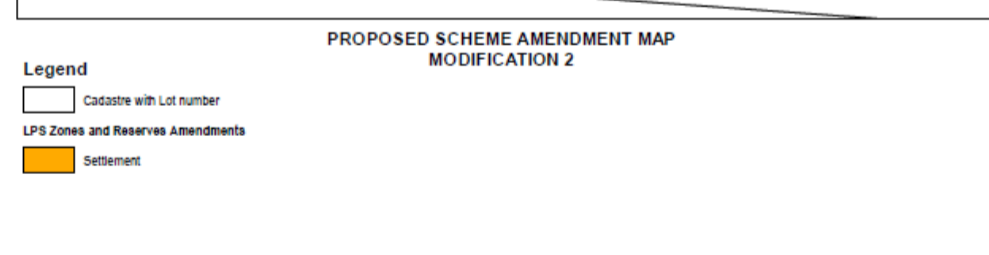

Figure 2 Modification No. 3.2





EXISTING SCHEME MAP  
MODIFICATION 3

- Legend**
- Cadastre with Lot number
  - LPS Zones**
  - Rural
  - Settlement
  - LPS Reserves**
  - ▬ Local Road
  - ▨ Primary Distributor Road
  - ▨ Public Purposes



PROPOSED SCHEME AMENDMENT MAP  
MODIFICATION 3

- Legend**
- Cadastre with Lot number
  - LPS Zones and Reserves Amendments**
  - ▨ Public Purposes
  - Settlement

Figure 3 Modification No. 3.3

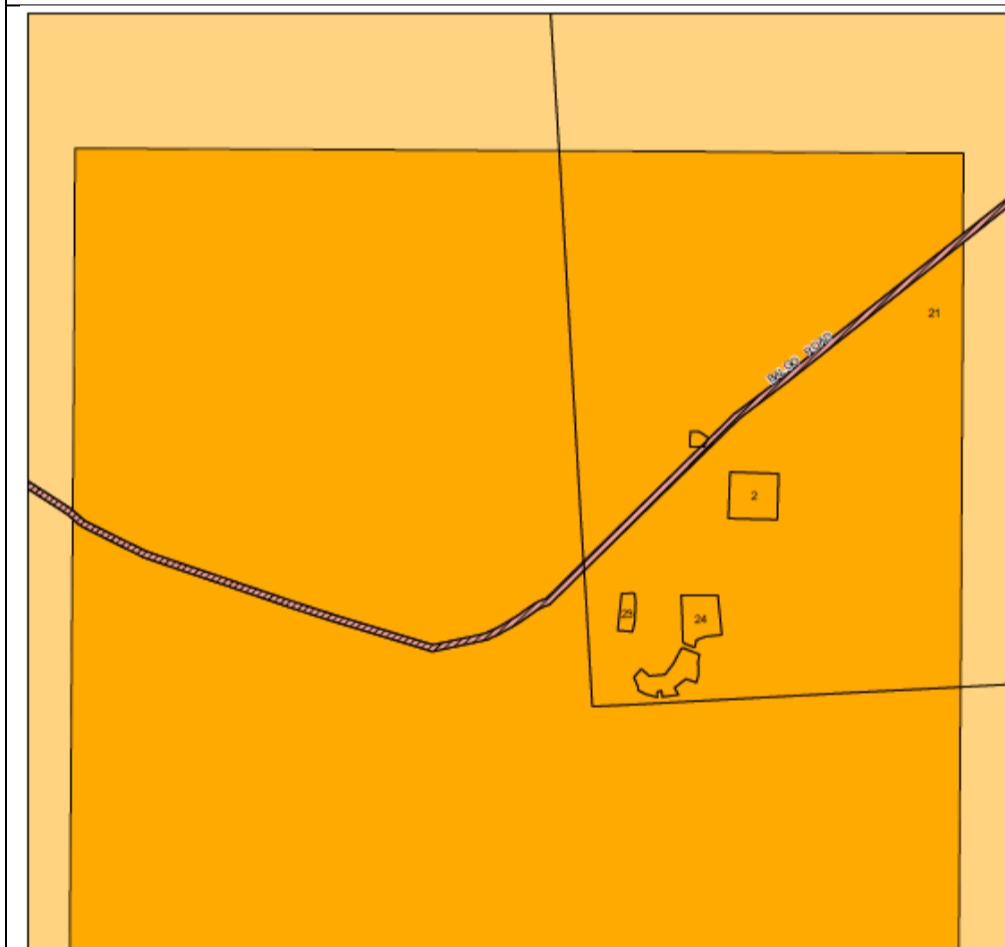

EXISTING SCHEME MAP  
MODIFICATION 4

- Legend**
- Cadastre with Lot number
  - LPS Zones**
  - Cultural and Natural Resource
  - Settlement
  - LPS Reserves**
  - ▨ Local Distributor Road

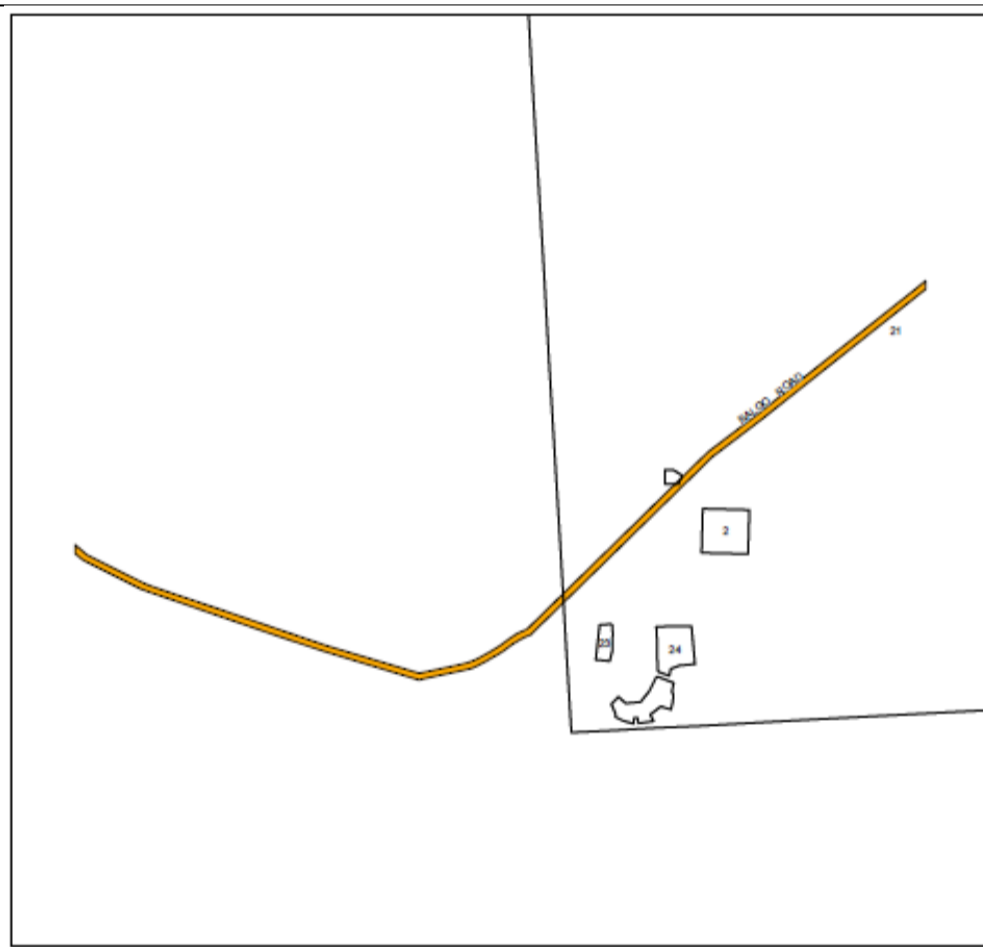

PROPOSED SCHEME AMENDMENT MAP  
MODIFICATION 4

- Legend**
- Cadastre with Lot number
  - LPS Zones and Reserves Amendments**
  - Settlement

Figure 4 Modification No. 3.4

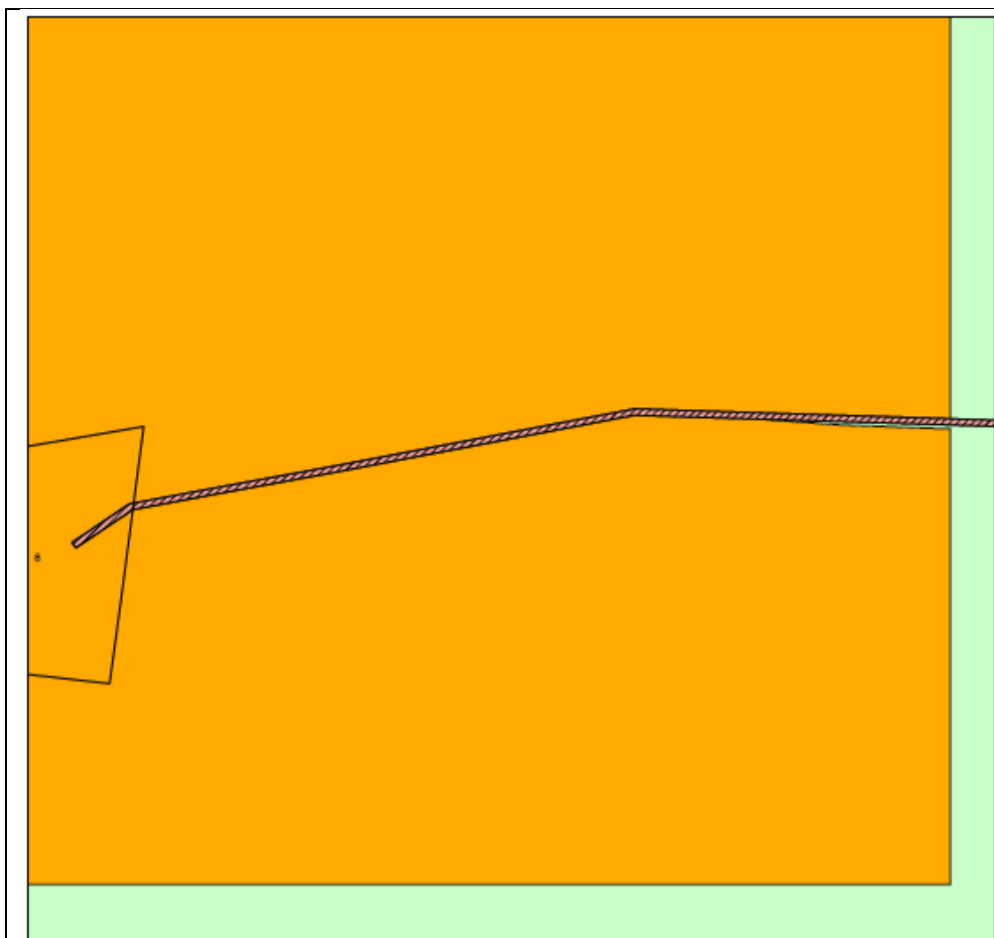

EXISTING SCHEME MAP  
MODIFICATION 5

- Legend**
- Cadastre with Lot number
  - LPS Zones**
  - Rural
  - Settlement
  - LPS Reserves**
  - Local Distributor Road

Figure 5 Modification No. 3.5

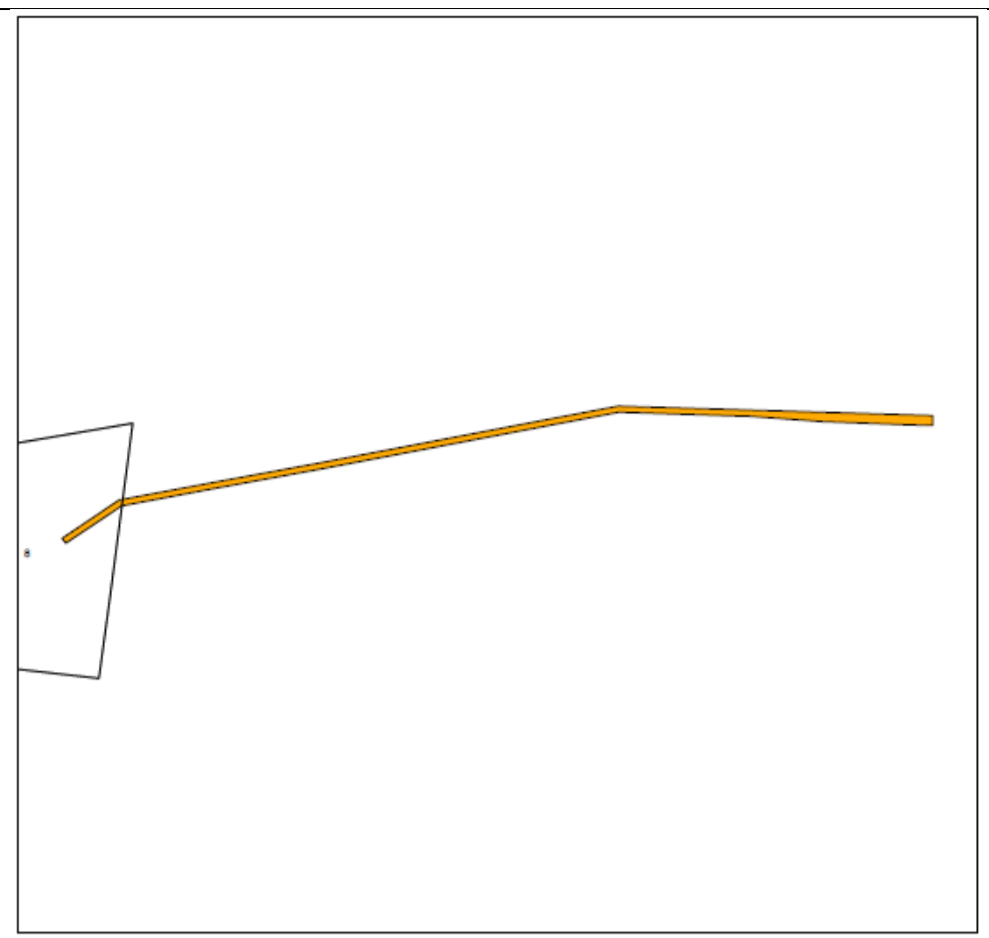

PROPOSED SCHEME AMENDMENT MAP  
MODIFICATION 5

- Legend**
- Cadastre with Lot number
  - LPS Zones and Reserves Amendments**
  - Settlement

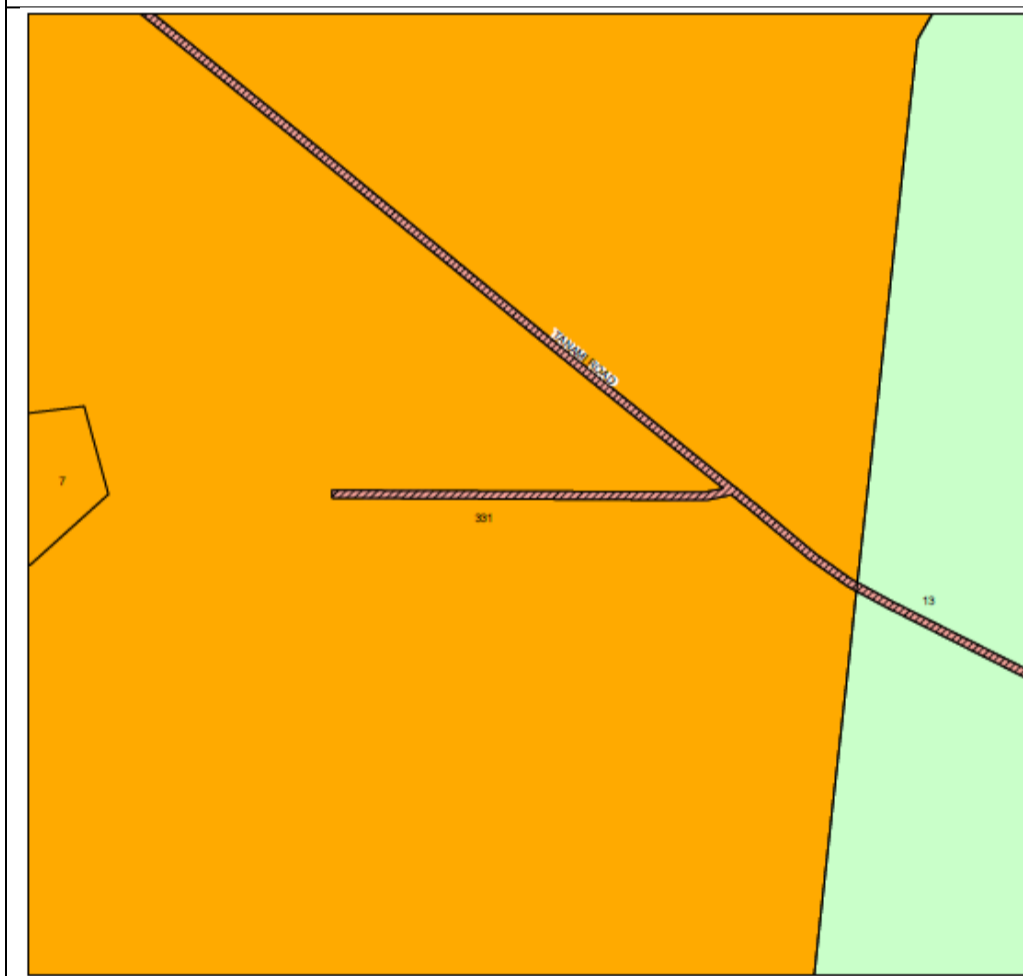

PROPOSED SCHEME AMENDMENT MAP  
MODIFICATION 6

- Legend**
- Cadastre with Lot number
  - LPS Zones**
  - Rural
  - Settlement
  - LPS Reserves**
  - Local Distributor Road

Figure 6 Modification No. 3.6

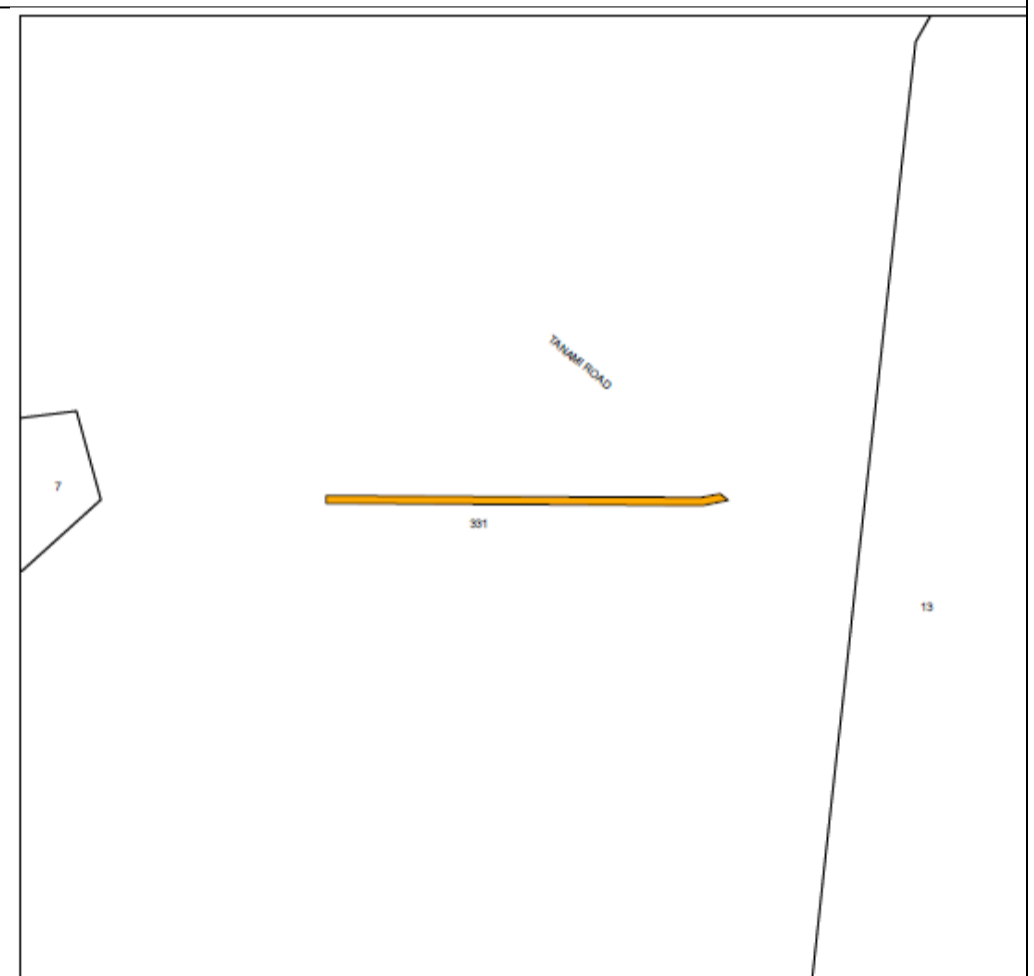

PROPOSED SCHEME AMENDMENT MAP  
MODIFICATION 6

- Legend**
- Cadastre with Lot number
  - LPS Zones and Reserves Amendments**
  - Settlement

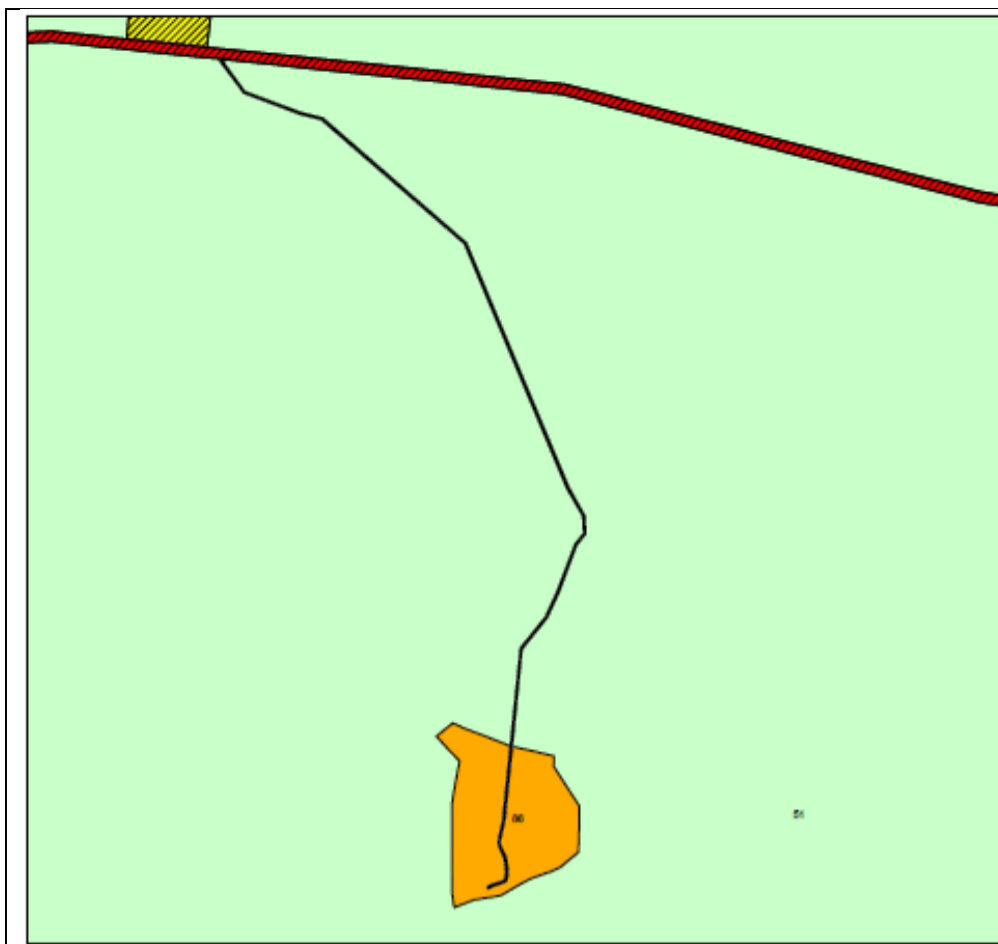

EXISTING SCHEME MAP  
MODIFICATION 7

- Legend**
- Cadastre with Lot number
  - LPS Zones**
  - Rural
  - Settlement
  - LPS Reserves**
  - Local Road
  - Primary Distributor Road
  - Public Purposes

Figure 7 Modification No. 3.7



PROPOSED SCHEME AMENDMENT MAP  
MODIFICATION 7

- Legend**
- Cadastre with Lot number
  - LPS Zones and Reserves Amendments**
  - Rural
  - Settlement

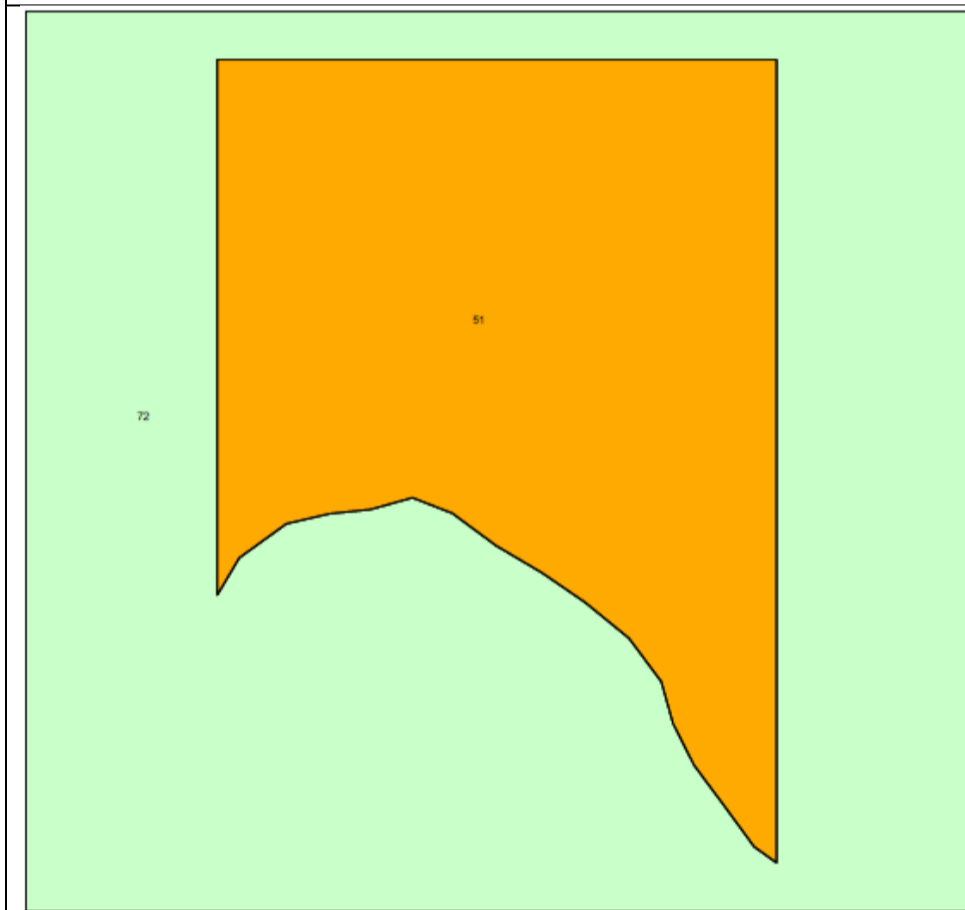

EXISTING SCHEME MAP  
MODIFICATION 8

- Legend**
- Cadastre with Lot number
  - LPS Zones**
  - Rural
  - Settlement

Figure 8 Modification No. 3.8

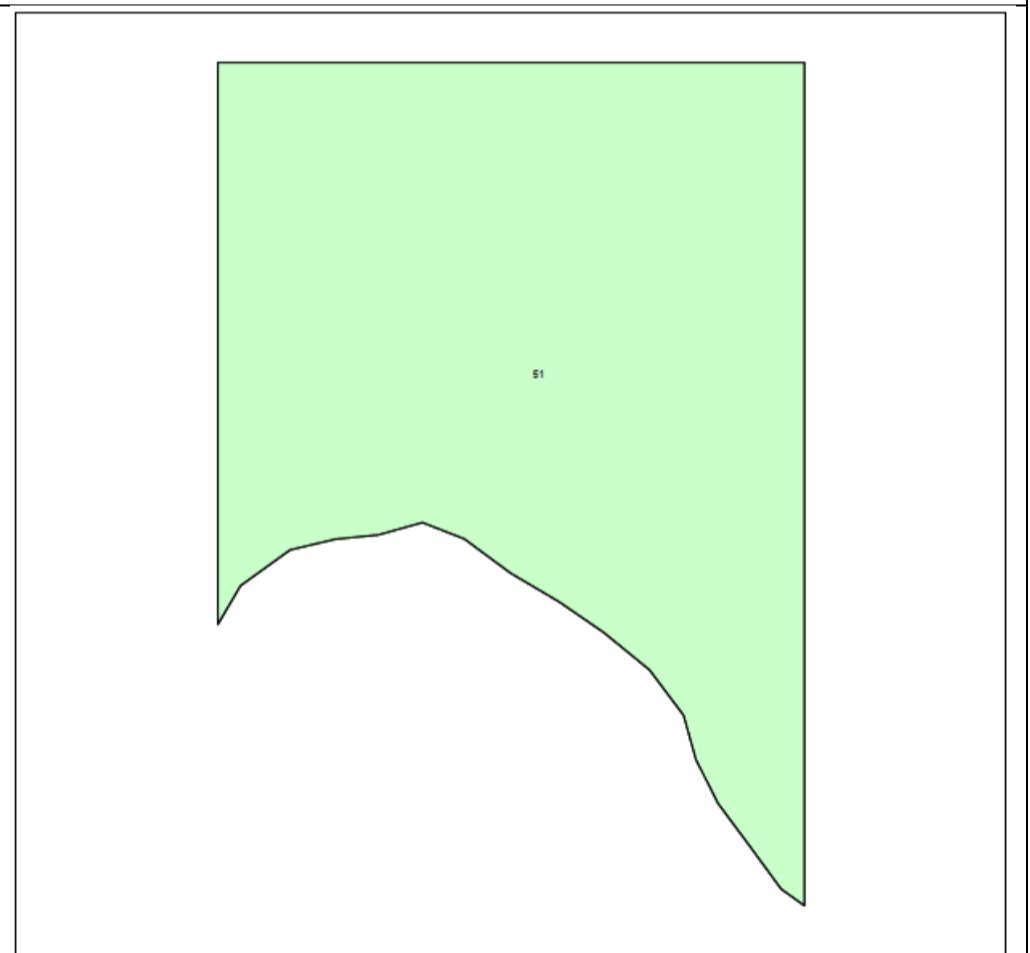

PROPOSED SCHEME AMENDMENT MAP  
MODIFICATION 8

- Legend**
- Cadastre with Lot number
  - LPS Zones and Reserves Amendments**
  - Rural